

**STRAUB-PLAST-OPEN-FLEX | Ø 21.3 - 114.3 mm**

Components	Materials
Casing	Nylon
Bolts	1.4301 / 1.4404
Bars	1.4301 / 1.4404
Nuts	1.4301

<b>Sealing sleeve</b> <b>EPDM</b>	Temp.: -20°C up to +100°C Medium: all qualities of water, waste water, air, solids and chemical products
<b>Sealing sleeve</b> <b>NBR</b>	Temp.: -20°C up to +80°C Medium: water, gas, oil, fuel and other hydrocarbons

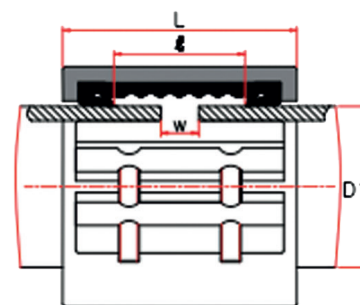
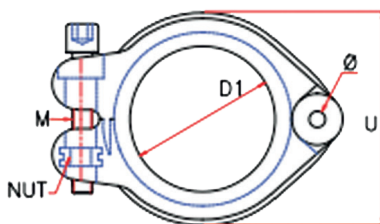

DN	OD [mm]	Clamping range [mm]	PN [bar]	Torque rate [Nm]	U [mm]	L [mm]	I [mm]
15	21,3	20.8 - 21.8	19,5	5,5	48	63	30
20	26,9	26.4 - 27.4	19,5	7	56	63	30
25	33,7	33.2 - 34.2	19,5	7	62	63	30
32	42,4	41.9 - 42.9	19,5	9	75	64	30
40	48,3	47.0 - 49.5	17,5	9	80	64	30
50	60,3	59.0 - 61.5	14,5	13	99	88	44
65	76,1	74.5 - 77.5	14,5	13	115	88	44
80	88,9	87.5 - 90.5	12,5	16,5	135	114	63
100	114,3	112.5 - 116.0	11,5	16,5	160	114	63

Typing errors may occur. Technical details are subject to change.

**REMARKS:**

- Follow fitting / disassembly instructions